

Upgrade instruction for gb20181016NSZ

This firmware can be applied to all cameras which got FW with ending NSZ.

Explicitly following models:

EBC-3310, EWPC-3450, EWPC-3451, EFD-3410, EFD3430,
EHC-3180, EHC-3181, EHC-3285, EHC-3288
ESD-3170, ESD-3280, ESD-3401 *

* For PTZ: If the single blocks like "main", "module", etc. must be upgraded too, please follow the instructions on page 2!

1. Go to System -> Software upgrade
2. At "Step1" search and select the ulmage_userland File
3. At "Step2" select "ulmage+userland.img".
4. At "Step3" push "Upgrade".

The screenshot shows the GEUTEBRÜCK web interface. The top navigation bar includes links for Home, System (selected), Streaming, Camera, Logout, and a status bar showing EFD-3410 and English. On the left, a sidebar menu lists various system functions: System, Security, Network, DDNS, Mail, FTP, HTTP, Events, Storage Management, Recording, Schedule, File Location, View Information, Factory Default, Software Version, and Software Upgrade (highlighted in orange). The main content area is titled 'Software Upgrade' and contains three steps: Step1: Upload the binary file with a search button 'Durchsuchen...'; Step2: Select binary file you want to upgrade with a dropdown menu showing 'ulmage+userland.img'; and Step3: Click the upgrade button to start the upgrade process with an 'Upgrade' button.

5. Wait until the camera has uploaded the Firmware to 100% and webpage has been reloaded and shown again.

6. Reload the Webpage once again with F5 or Reload button of web browser.

NOTE: In very few cases functions and/or web menu surfaces can be disturbed. If so, you should execute a "Partial Restore". Please be aware, that after partial restoring all parameters (without network parameters) will get its default values!

Upgrade instructions for PTZ domes of type ESD-3xx0

ESD-3170 and ESD-3280:

After the successful upgrade of the base firmware (Uimage...), you should follow these steps:

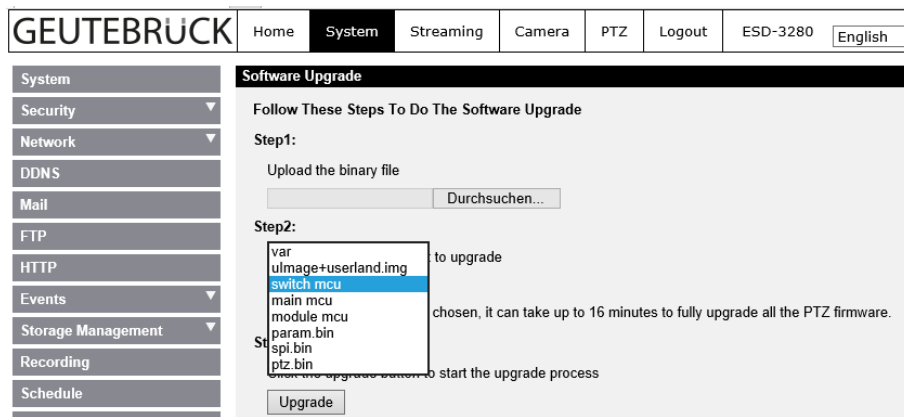

- 1) Upload binary file "switch_SI2R_30E1.bin", select "Switch mcu" and press "Upgrade" (for old power board use "switch_SIBD_30E1.bin").
- 2) Upload binary file "main_M02R_4151.bin", select "main mcu" and press "Upgrade".
- 3) Upload binary file "module_Xarina_imx291_30X_1509_CAN.bin", select "module mcu" and press "Upgrade".
- 4) Upload binary file "param_G4_0B04_S2.bin", select "param.bin" and press "Upgrade".
- 5) Upload binary file "spi.bin", select "spi.bin" and press "Upgrade".

NOTE: In very few cases functions and/or web menu surfaces can be disturbed. If so, you should execute a "Partial Restore". Please be aware, that after partial restoring all parameters (without network parameters) will get its default values!

ESD-3401:

After the successful upgrade of the base firmware (Uimage...), you should follow these steps:

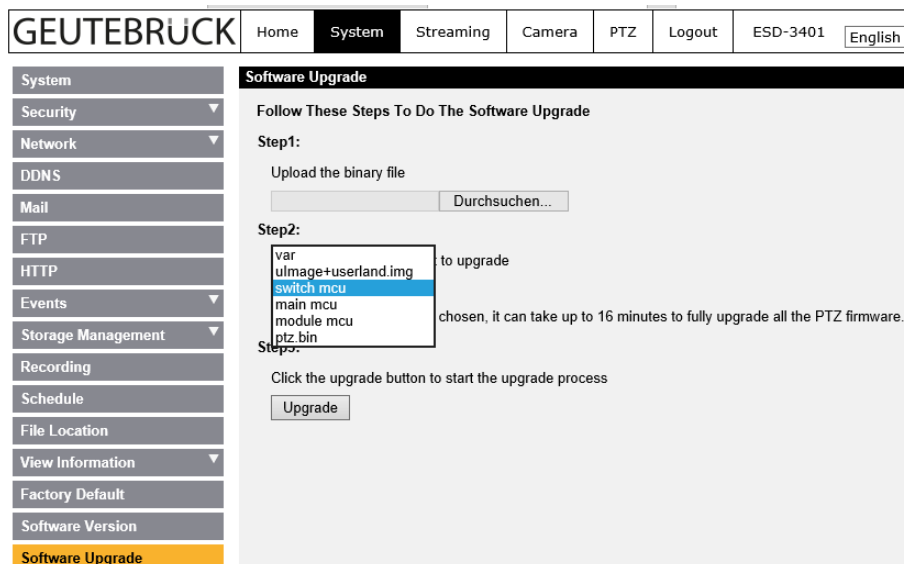

- 1) Upload binary file "switch_P02R_5092.bin", select "Switch mcu" and press "Upgrade".
- 2) Upload binary file "main_T02R_5092.bin", select "main mcu" and press "Upgrade".
- 3) Upload binary file "module_IRPTZ_TAM30_20161220_01.bin", select "module mcu" and press "Upgrade".

NOTE: In very few cases functions and/or web menu surfaces can be disturbed. If so, you should execute a "Partial Restore". Please be aware, that after partial restoring all parameters (without network parameters) will get its default values!