

GEUTEBRÜCK

G-SIM

Software Version 9.3.1

---

**Release Notes**

## Table of contents

Release Notes ..... 3

Feature Description .....4

Update Guide..... 5

System Specifications ..... 7

## G-SIM 9.3.1

Software	Type	Short Description	Detailed Description
New Feature	OpCon	Showing of Rectangles for VideoResult Action	The viewers of the OpCon are now able to display the rectangles of eventdata from the VideoResult action.
Information	ManCon	Removing of Adaptive Font Feature	The original adaptive font feature was removed from the settings and is working dynamically per default in accordance to the chosen viewer size.
Bugfix	Failover	Viewer sticks to Failover Camera	The issue in the camera failover which was fixed caused the viewer to show the failover camera instead of the primary camera.
Bugfix	ManCon	"Select All" Button in User Privileges	An issue with the "Select All" button was fixed, which led to unlogical privileges of PTZ controls after usage.
Bugfix	OpCon	Unsuccessful OpCon Connection after Secondary Channel +NVR Failover	An issue was fixed, which led to an unsuccessful OpCon server connection after a mediasource with secondary channels and NVR failover was configured.
Bugfix	ManCon	Alarm Instance still selected after Mediasource Change	An issue with the alarm instances was fixed, which led to a still selected alarm instance after the respective mediasource was changed to another one.
Bugfix	ManCon	Slow Failover Configuration	An issue in the failover configuration was fixed, which led to a slow processing of new configurations.
Bugfix	ManCon	Error Message during Configuration	An issue with the secondary channel was fixed, which led to an error message during configuration.
Bugfix	OpCon	Unshown SNMP Alarm Names	An issue with the SNMP alarm was fixed, which led to unshown instance names in the OpCon.
Bugfix	MBEG+	MBEG Controls on ReCon+	An MBEG+ related issue was fixed, which led to non functional controls in combination with a ReCon.
Bugfix	OpCon	OSD Scaling Issue	An issue in the OSD settings was fixed, which led to a fault display of OSD information.
Bugfix	MBEG+	Non-functional Camera Switching with MBEG+	An issue in the MBEG+/OpCon combination was fixed, which led to a non-working functionality of switching cameras based on their global number.

### **IP / Hostname / FQDN Support & Configuration**

It is now possible to specify the address type which is used as basis for the connection from an OpCon or ReCon to the server, i.e. FQDN, hostname or IP address. The requirement for hostname lookup is not necessary anymore.

### **Important Information in Advance**

The upcoming release after this will include a new enhanced security mode, which enables higher encryption standards and improves the foundation of security in G-SIM.

The activation of this mode will be available during the installation process for new G-SIM environments, but is incompatible towards previous system versions in mixed environments.

Please note, that this mode will be default in one of upcoming releases afterwards and other security settings during the installation will be therefore removed.

### G-SIM Updating Guide

Starting with Version 9.3.0 we implemented security related fixes which leads to incompatibility to older G-SIM versions. That means that clients from Version 9.3.0 are not able to connect to older GSimServers.

Nevertheless, we added a compatibility mode for updating without interruptions of operation.

**Please follow these instructions to avoid interruptions of operation while updating. If it is not necessary to have the system in operation mode while updating is in process you can skip step 1.**

**ATTENTION: It is not possible to downgrade after updating to G-SIM X PANOPTICON without loss of data. Please make a backup of all SQL databases and the G-SIM setup before updating to be able to install an older version again.**

1. Install DotNet Framework 4.8  
The GSIM Setup Software will be stopped when this Framework is not installed
2. Update all clients which should work without interruption while updating with compatibility mode enabled.

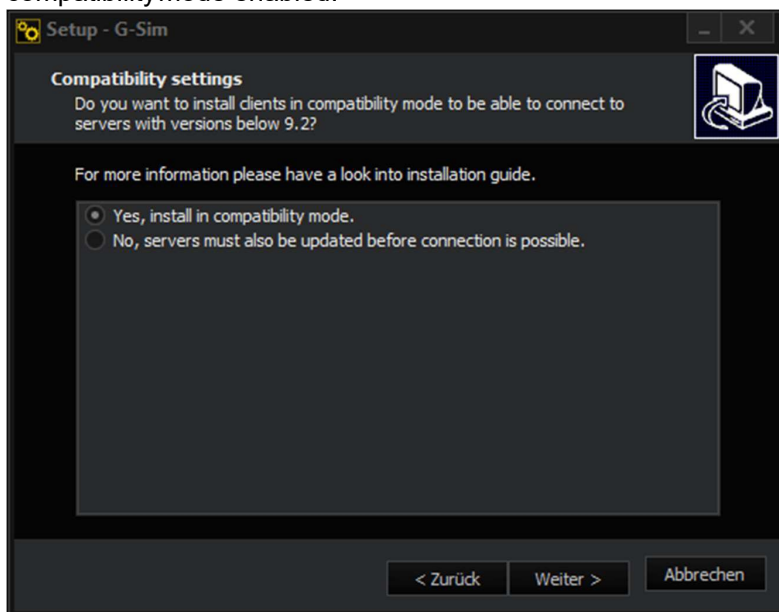

3. Update all G-SIM Servers.
4. Update all clients again without compatibility mode.

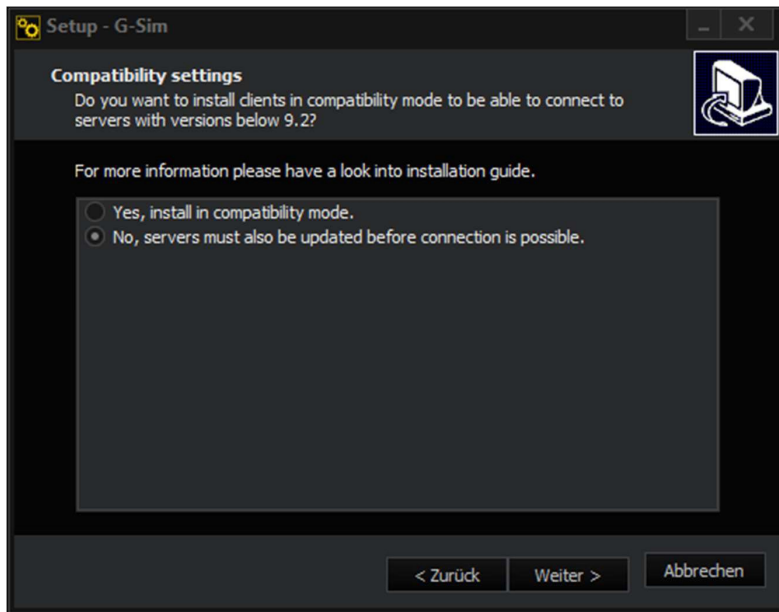

**Please note:**

A system with a control server is no longer supported with G-SIM X Panopticon. You can now use the global function, which allows all servers to communicate directly with one another.

- The servers are equal and they communicate with each other directly. There is no hierarchy with a “main” server (in contrast to the control server with sub-servers).
- All administrators can access all servers. The reason is that users and restrictions are mapped and synchronized throughout the system. Example: An administrator of site A can log into site B and has the same rights.
- For the operator there are no changes to a system with a control server. You can still be subject to restrictions on individual sites. You can also see the information on several sites here if necessary.
- You can access a guide how to migrate a system with a control server to a global system online (<https://www.geutebrueck.com/gsim-help>).

**Note:**

For larger projects, the general conditions under which the system is operated must be analysed individually. For this, contact Geutebrück GmbH directly so that recommendations / specifications can be made.

The following tables show the recommended minimum requirements for servers and clients of your system. Due to the wide range of possible applications and use cases, additional factors may have to be taken into account that influence the system requirements. You will find information on this in the general recommendations. If the factors mentioned there apply to your system, please contact Geutebrück GmbH to validate your system requirements.

#### G-SIM Server Minimum Requirements

		Number Recorder		Number OpCons		Number Cameras		Cluster Installation	Global System
		<5	>5	<5	>5	<100	>100		
Operating System	Windows 10	X		X		X			
	Windows Server 2016 / 2019		X		X		X	X	X
CPU	Intel Core i7 Kaby Lake	X		X		X			
	Server CPU Xeon E3 1275 V6 up		X		X		X	X	X
Microsoft SQL Server	SQL Server Express 2014/2019	X	X	X	X	X	X		
	SQL Server Standard 2014/2019							X	X
GPU	No GPU necessary as long as no G-SIM client is installed.								
Memory	16 GB								
Free hard disk space	80 GB								
Microsoft .Net Version	4.8								
Network Interface	1Gbit/s								
Hardware Generation	We recommend the usage of the current G-ST generation, nevertheless a Global system is only supported on G-ST hardware.								

Systems with increased system requirements use Windows Server OS with a corresponding system platform.

## G-SIM Client Minimum Requirements

Memory	16 GB
Free hard disk space	8 GB (6 GB free)
CPU support	7. Generation Intel Core i5 (min. 2,4 GHz) or higher
GPU	Intel GPU Consider the CPU and graphics driver recommendations listed below
Operating system	Windows 10
Microsoft .Net Version	4.8
Network Interface	1Gbit/s

\* These values are a recommendation if no other third party services are running on this hardware.

## Influencing Factors and Recommendations

The following factors influence the system load and accordingly the system requirements. If your system meets one or more of these criteria, please contact Geutebrück GmbH to validate your system requirements.

Influencing factors	Recommendation
System with many G-Core Actions	Use of several agents.
System with multiple agents	Microsoft SQL Server Standard and Windows Server 2016 / 2019 operating system.
Use of Microsoft SQL Server Standard	Microsoft SQL Server Standard can use several CPU cores, so that the CPU load can be distributed over several cores. This must be considered when selecting the hardware
System with retriggered events, creation of new event instances	Increased system requirements
System with >5 alarms per minute or complex alarm configurations (viewer group alarms, database playback, metadata display, etc.)	Increased system requirements
System with >5 events per second or complex event display with database search	Increased system requirements
Parallel use of the process data search on several clients	Increased system requirements
Global System - Interconnection of several G-Sim installations	Increased system requirements
System running in a virtual environment	Increased system requirements
System with 3rd party services and applications	Increased system requirements



For maximum supported system sizes, please refer to the technical data and clarify these with Geutebrück GmbH before planning the system.

## CPU and graphics driver recommendations

We recommend the following CPU and Intel graphics drivers. We cannot guarantee functionality and performance without using the recommended drivers. Any new version may cause performance and stability problems.

Product Collection	Code Name	Processor Number	Processor Graphics	Graphic Driver Version	Graphic Driver Version
10th Generation Intel® Core™ i3	Comet Lake	Core i3000 Serie Prozessor	Intel® UHD Graphics 630		27.20.100.9466 DHC (Win 10 21H1)
9. Generation Intel® Core™ i3, i5, i7, i9 Processors		Core i900 Serie Processor	Intel® UHD Graphics 630		27.20.100.9168 DHC (Win 10 1809)
		Core i9500 Serie Processor	Intel® UHD Graphics 630		27.20.100.9168 DHC (Win 10 1809)
		Core i9700 Serie Processor	Intel® UHD Graphics 630		27.20.100.9168 DHC (Win 10 1809)
		Core i9900K Serie Processor	Intel® UHD Graphics 630		27.20.100.9168 DHC (Win 10 1809)
		Xeon E-2244G Processor	Intel® UHD Graphics P630		27.20.100.9168 DHC (Win Serv 2019 1809)
8. Generation Intel® Core™ i3, i5, i7 Processors	Coffee Lake	Core i8000 Serie Processor	Intel® UHD Graphics 630		25.20.100.6519 DHC (Win 10 1809)
7th Generation Intel® Core™ i3, i5, i7 Processors	Kaby Lake	Core i3- 7100TE Processor 3.9Ghz Core i5- 7500 Processor 3.4Ghz Core i7- 7700 Processor 3.6Ghz	Intel® HD Graphics 630	21.20.16.4678 (Win 10 1607)	26.20.100.7263 (Win 10 1809, Legacy) 26.20.100.7584 (Win 10 1809, DCH)
6th generation Intel® Core™ i3, i5, i7 Processors	Skylake	Core i3- 6100TE Processor 2.7Ghz Core i5- 6500 Processor 3.2Ghz Core i7- 6700 Processor 3.4Ghz	Intel® HD Graphics 530	21.20.16.4639 (Win 8.1)	
4th generation Intel® Core™ i3, i5, i7 Processors	Haswell	Core i3-4330 Processor 3.5Ghz Core i5-4570S Processor 2.9Ghz Core i7-4770S Processor 3.1GHz	Intel® HD Graphics 4600	15.36.28.4332 (Win 8.1)	20.19.15.4377 (Win 10 1607)
Intel® Xeon® Processors E3 v6 Familie	Kaby Lake	Intel XEON E31275V6	Intel® HD Graphics P630	21.20.16.4678 (Win Serv 2016)	
Intel® Celeron® Processors J Serie	Gemini Lake	Intel Celeron J4105 2.5 Ghz	Intel® UHD Graphics 600	25.20.100.6582 (Win 10 1607)	

These drivers may not be part of the G-SIM installer. Please refer to the Geutebrück Knowledge Base for an up-to-date list:

<https://support.geutebrueck.com/de/search/detail/intel-gpu-driver-recommendation.html>

## Contact information

If you have any questions about the specific requirements of your system, you can contact Geutebrück GmbH:

Geutebrück GmbH

Department Presales Call: +49 2645 1370

E-Mail: [info@geutebrueck.com](mailto:info@geutebrueck.com)

Technical alterations reserved.

**GEUTEBRÜCK GmbH**

Im Nassen 7-9 | D-53578 Windhagen | Tel. +49 (0)2645 137-0 | Fax-999 | E-mail: [info@geutebrueck.com](mailto:info@geutebrueck.com) | Web: [www.geutebrueck.com](http://www.geutebrueck.com)